

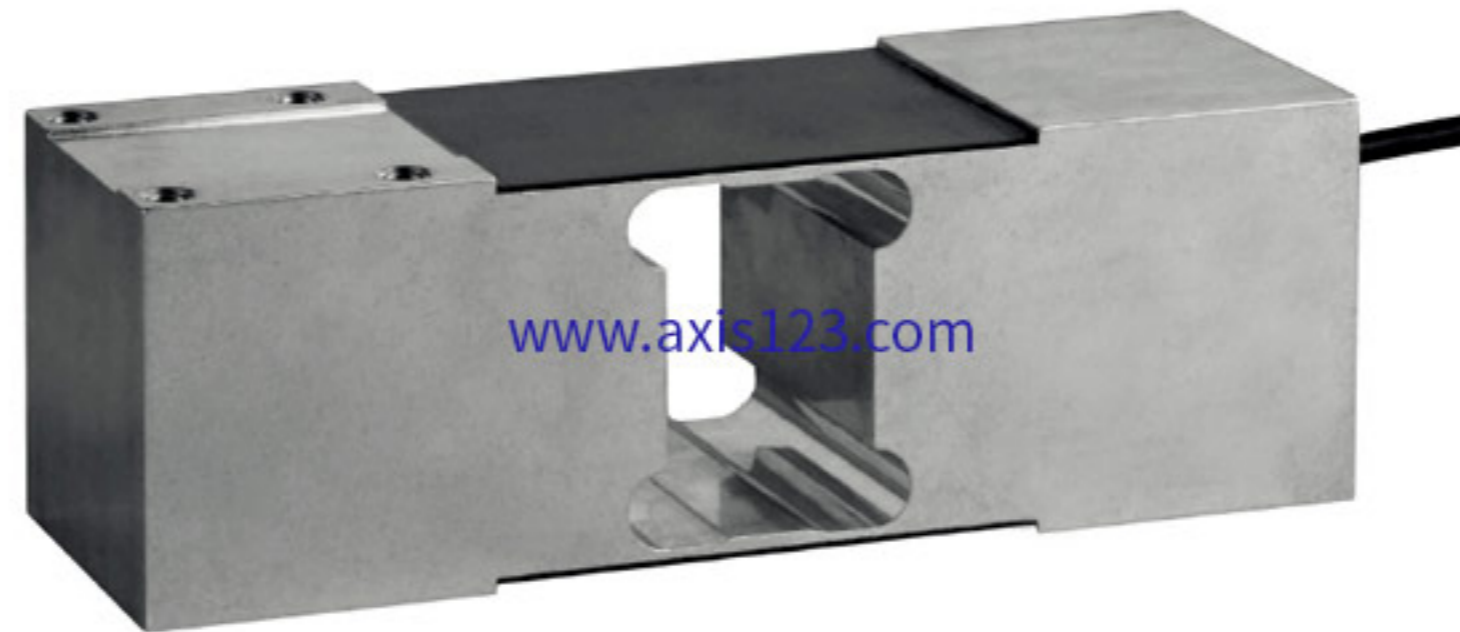

Since 1994, DIGITAL LEADER Axis Sensitive Co. Ltd
Industrial Explosion Proof Load Cell



MODEL : PC60-EXP



RoHS
compliant

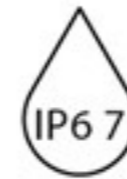

제품 규격 [UNIT : mm]

Product Specification

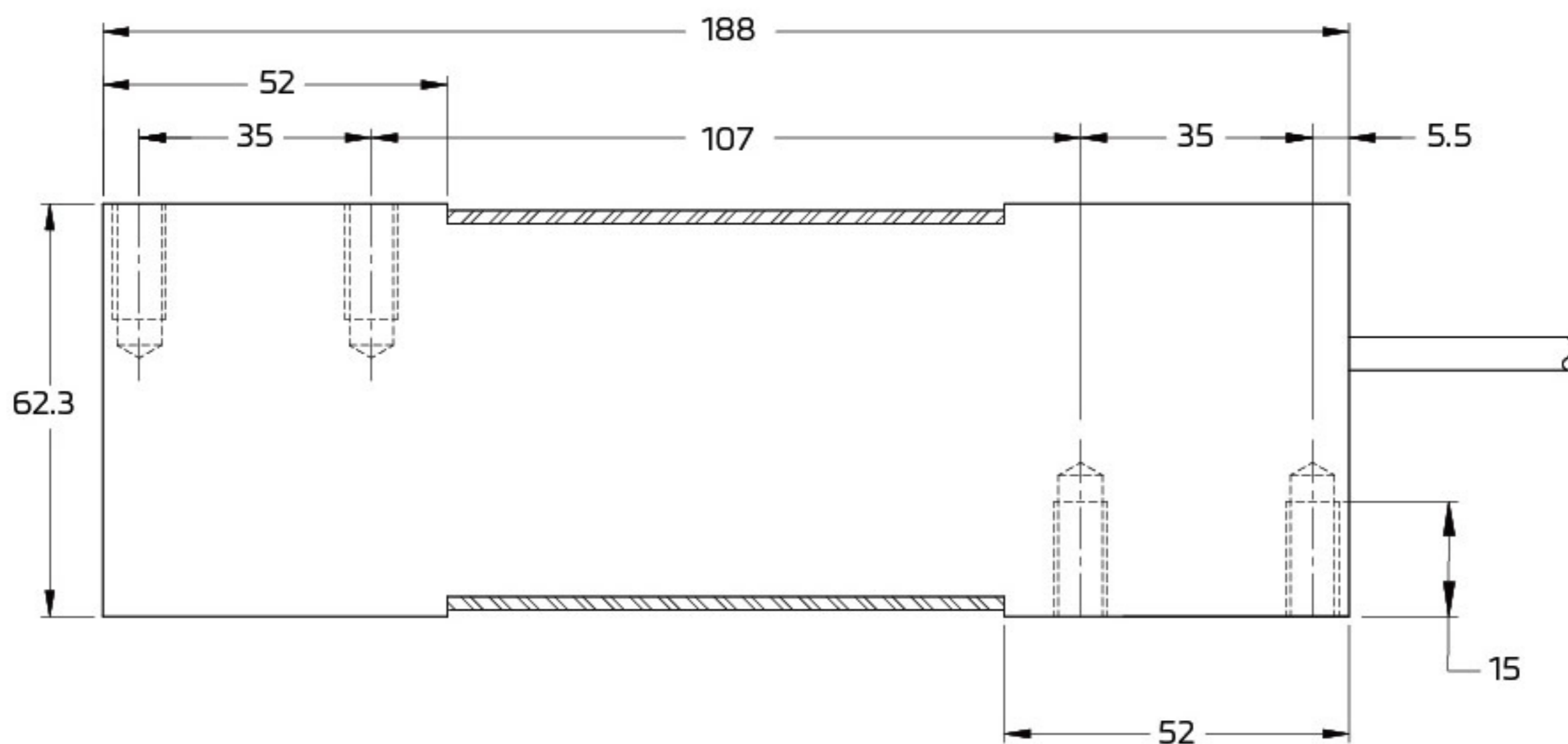

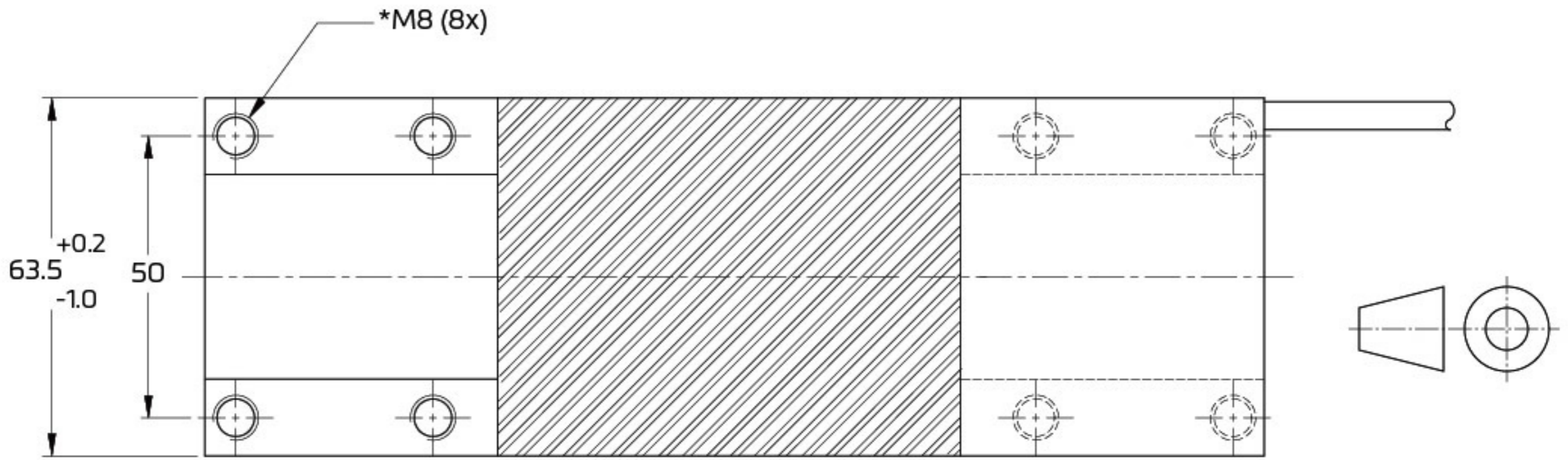

The load cell is provided with a shielded, 6 conductor cable (AWG 26).

Cable jacket: polyurethane

Cable length: 3 m

Cable diameter: 5.8 mm

The shield is connected to the load cell body

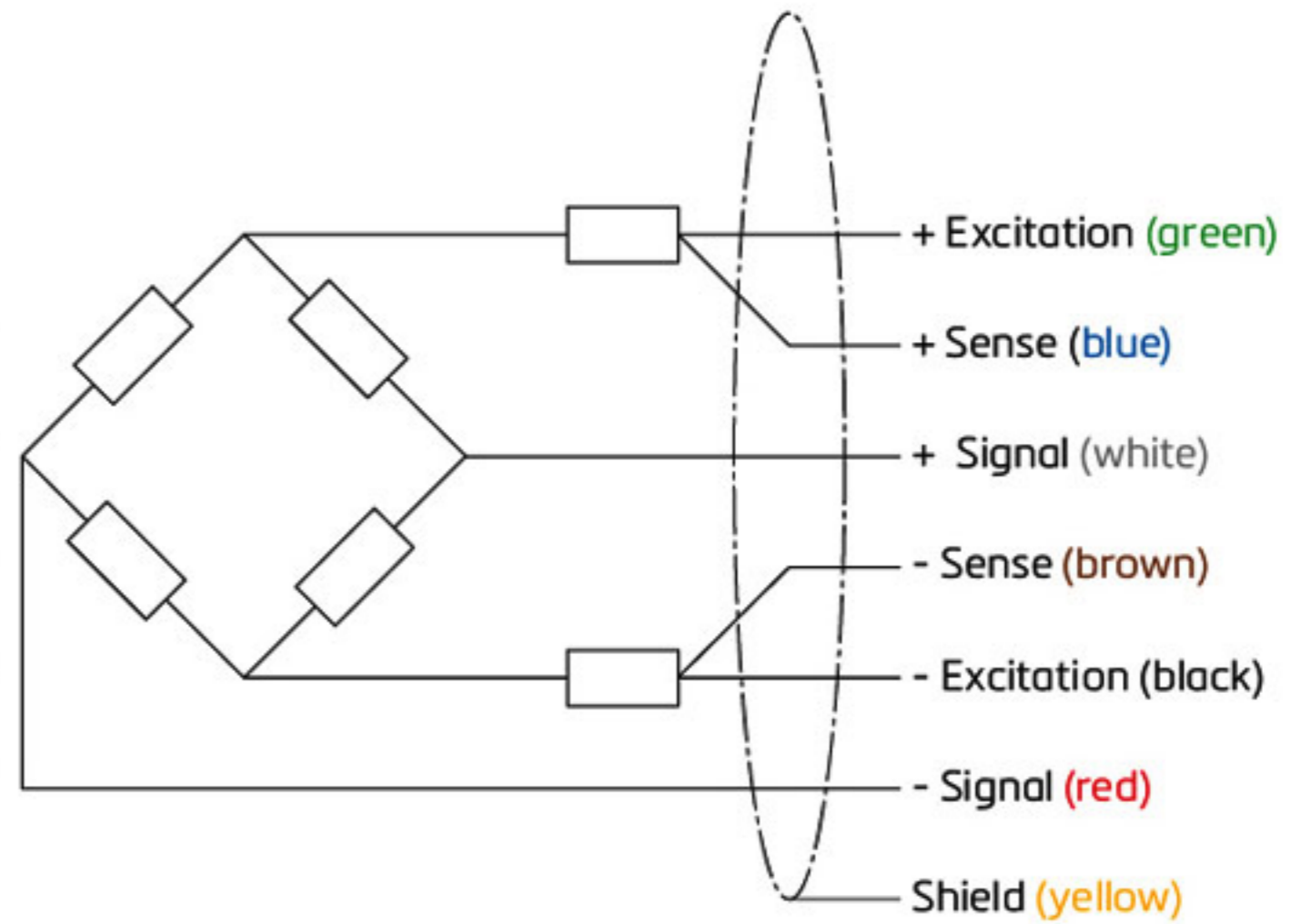

- ▶ 벤치 스케일 및 플랫폼 스케일, 의료 저울에 적합한 중형 로드셀
- ▶ 내구성을 보장하기 위해 알루미늄과 포팅 컴파운드로 환격적으로 밀봉
- ▶ 30kg~750kg 까지의 다양한 용량, 3000d OML인증 제품

Maximum capacity (E_{max})	kg	30 / 50 / 100 / 150 / 200 / 300 / 500 / 750	
Accuracy class according to OIML R60		(GP)	C3
Maximum number of verification intervals (n_{max})		n.a.	3,000
Minimum load cell verification interval (v_{min})		n.a.	$E_{max} / 7,500$
Temperature effect on minimum dead load output (TC_0)	%*RO/10°C	± 0.0400	± 0.0187
Temperature effect on sensitivity (TC_{RO})	%*RO/10°C	± 0.0200	± 0.0100
Combined error	%*RO	± 0.0500	± 0.0200
Non-linearity	%*RO	± 0.0400	± 0.0166
Hysteresis	%*RO	± 0.0400	± 0.0166
Creep error (30 minutes) / DR	%*RO	± 0.0600	± 0.0166
Optional: Min. load cell verification interval ($v_{min opt}$)		n.a.	$E_{max} / 15,000$
Optional: Temp. effect on min. dead load output ($TC_0 opt$)	%*RO/10°C	n.a.	± 0.0093
Rated Output (RO)	mV/V	2 ± 10%	
Zero balance	%*RO	± 5	
Excitation voltage	V	5...15	
Input resistance (R_{LC})	Ω	413 ± 20	
Output resistance (R_{out})	Ω	350 ± 25	
Insulation resistance (100 V DC)	MΩ	≥ 5000	
Safe load limit (E_{lim})	%* E_{max}	150	
Ultimate load	%* E_{max}	300	
Safe side load	%* E_{max}	100	
Maximum platform size; loading acc. to OIML R76	mm	600 x 600	
Maximum off centre distance at maximum capacity	mm	200	
Compensated temperature range	°C	-10...+40	
Operating temperature range	°C	-20...+65 (ATEX -20...+60)	
Load cell material		aluminium, optional clear anodized	
Sealing		potted	
Protection according EN 60 529		IP67	
Packet weight	kg	2	

- › 알루미늄 구조 / 포팅으로 환경 친화적인 밀봉
- › 다양한 용량 범위
- › 플랫폼 규격 600 X 600mm
- › 로드셀 케이블 : 폴리 우레탄 3m x 5.8mm
- › EN 60 529에 따른 보호 : IP67