

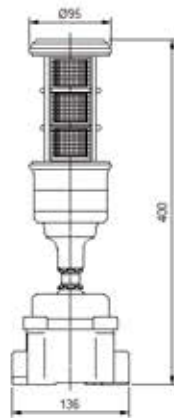

AC 110V, 220V

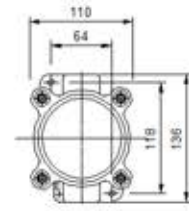

DC 24V

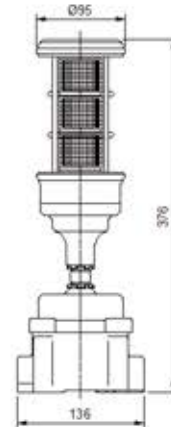

Ex d nR IIC T6 IP65

• Data

최대 전압	모 델	무게(kg)	Materials
AC 220V	NST-22	2.85	Body : Cast Aluminium Alloy
AC 110V	NST-11	2.85	Cover : Cast Aluminium Alloy
DC 24V	NST-24	2.55	Glass : Acrylic
AC 600V	RTHB-01	Max. 20A	Cast Aluminium



FUL-LED-S

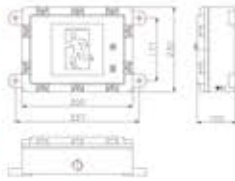

FUL-LED-M

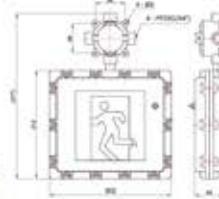

FUL-LED-E

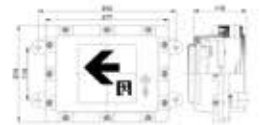

Ex d IIB+H2 T6

• Data

최대 전압	모 델	규 격	규 격	Dimension(mm)			
				A	B	ØX	H
AC 220V 60Hz	FUL-LED-S	300×230×105	Cast Aluminium Alloy	Test	HUB	LED	LED
DC 3.6V	FUL-LED-M	352×312×84		Botton	PF 3/4"	Green	Red
60min / 3.1W	FUL-LED-E	277×215×118					



FUFL-LED-TM

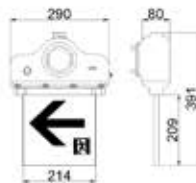

• Operating Form

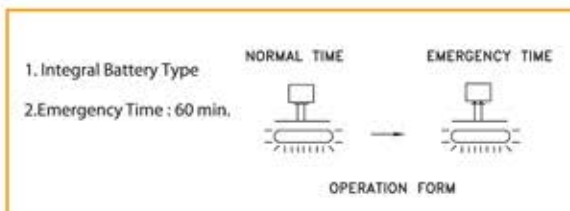

• Wiring Diagram

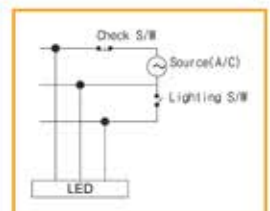

Ex d IIB+H2 T6 IP65

• Data

최대 전압	모 델	규 격	규 격	Dimension(mm)			
				A	B	ØX	H
AC 220V 200mA	FUFL-LED-TM	290×391×80	Cast Aluminium Alloy	Test Botton	HUB PF 3/4"	LED Green	LED Red