

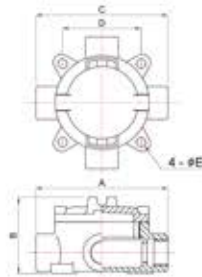

Four - Way (GA)

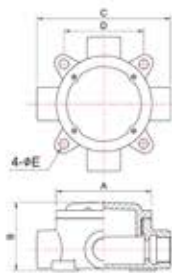

Four - Way (SB)



Ex d IIC T6

• Data

모 델	Hub		Dimensions (mm)				무 게
	Size (PF)		A	B	C	D	
GA-16	16 (1/2")	95	69	134	85	7	1.8
GA-22	22 (3/4")	95	75	134	85	7	1.9
GA-28	28 (1")	95	83	138	85	7	1.9
GA-36	36 (1 1/4")	125	100	170	106	9	3.1
GA-42	42 (1 1/2")	125	107	170	106	9	3.1
GA-54	54 (2")	160	135	228	142	10	6.4
GA-70	70 (2 1/2")	-	-	-	4.6	-	-

Ex e II

모 델	Hub		Dimensions (mm)				무 게
	Size (PF)		A	B	C	D	
SB F16	16 (1/2")	95	59	134	83	7	1.8
SB F22	22 (3/4")	95	63	134	83	7	1.8
SB F28	28 (1")	95	76	138	83	7	2
SB F36	36 (1 1/4")	125	85	170	83	9	3.4
SB F42	42 (1 1/2")	125	95	170	83	9	3.8
SB F54	54 (2")	160	118	228	83	10	5.4
SB F70	70 (2 1/2")	-	-	-	-	-	-



Adapter (XR)

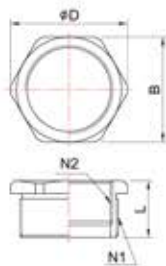

Socket (XS)

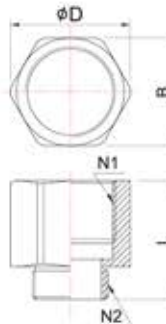

Ex d IIC

• Data

Thread Size (PF)		Adapter				Socket Types		
		Dimension (mm)			무 게	Dimension (mm)		
N1	N2	B	øD	L	모 델	kg	B	øD
22(3/4")	16 (1/2")	32	35	22	XR-110	0.09	32	35
	28(1")	16 (1/2")	38	41	26	XR-210	0.11	38
36(1-1/4")	22 (3/4")	36	39	26	XR-211	0.11	38	41
	16 (1/2")	45	48	28	XR-310	0.15	46	50
	22 (3/4")	45	48	28	XR-311	0.15	46	50
42(1-1/2")	28 (1")	45	48	28	XR-312	0.15	46	50
	16 (1/2")	51	54	30	XR-410	0.22	54	58
	22 (3/4")	51	54	30	XR-411	0.22	54	58
	28 (1")	51	54	30	XR-412	0.22	54	58
54(2")	36 (1 1/4")	51	54	30	XR-413	0.22	54	58
	16 (1/2")	63	67	32	XR-510	0.45	67	73
	22 (3/4")	63	67	32	XR-511	0.45	67	73
	28 (1")	63	67	32	XR-512	0.45	67	73
	36 (1 1/4")	63	67	32	XR-513	0.45	67	73
70(2-1/2")	42 (1 1/2")	63	67	32	XR-514	0.45	67	73
	28 (1")	79	83	40	XR-612	0.63	82	85
	36 (1 1/4")	79	83	40	XR-613	0.63	82	85
	42 (1 1/2")	79	83	40	XR-614	0.63	82	85
	54 (2")	79	83	40	XR-615	0.63	82	85
	28 (1")	93	97	42	XR-712	0.7	95	100
82(3")	36 (1 1/4")	93	97	42	XR-713	0.7	95	100
	42 (1 1/2")	93	97	42	XR-714	0.7	95	100
	54 (2")	93	97	42	XR-715	0.7	95	100
	70 (2 1/2")	93	97	42	XR-716	0.7	95	100
104(4")	54 (2")	128	134	46	XR-915	0.89	128	134
	70 (2 1/2")	128	134	46	XR-916	0.89	128	134
	82 (3")	128	134	46	XR-917	0.89	128	134