



Since 1994, DIGITAL LEADER Axis Sensitive Co. Ltd



Industrial Explosion Proof Balance Scales

MODEL : FCJB-IIB형



www.axis123.com



제품 규격 [UNIT : mm]

Product Specification

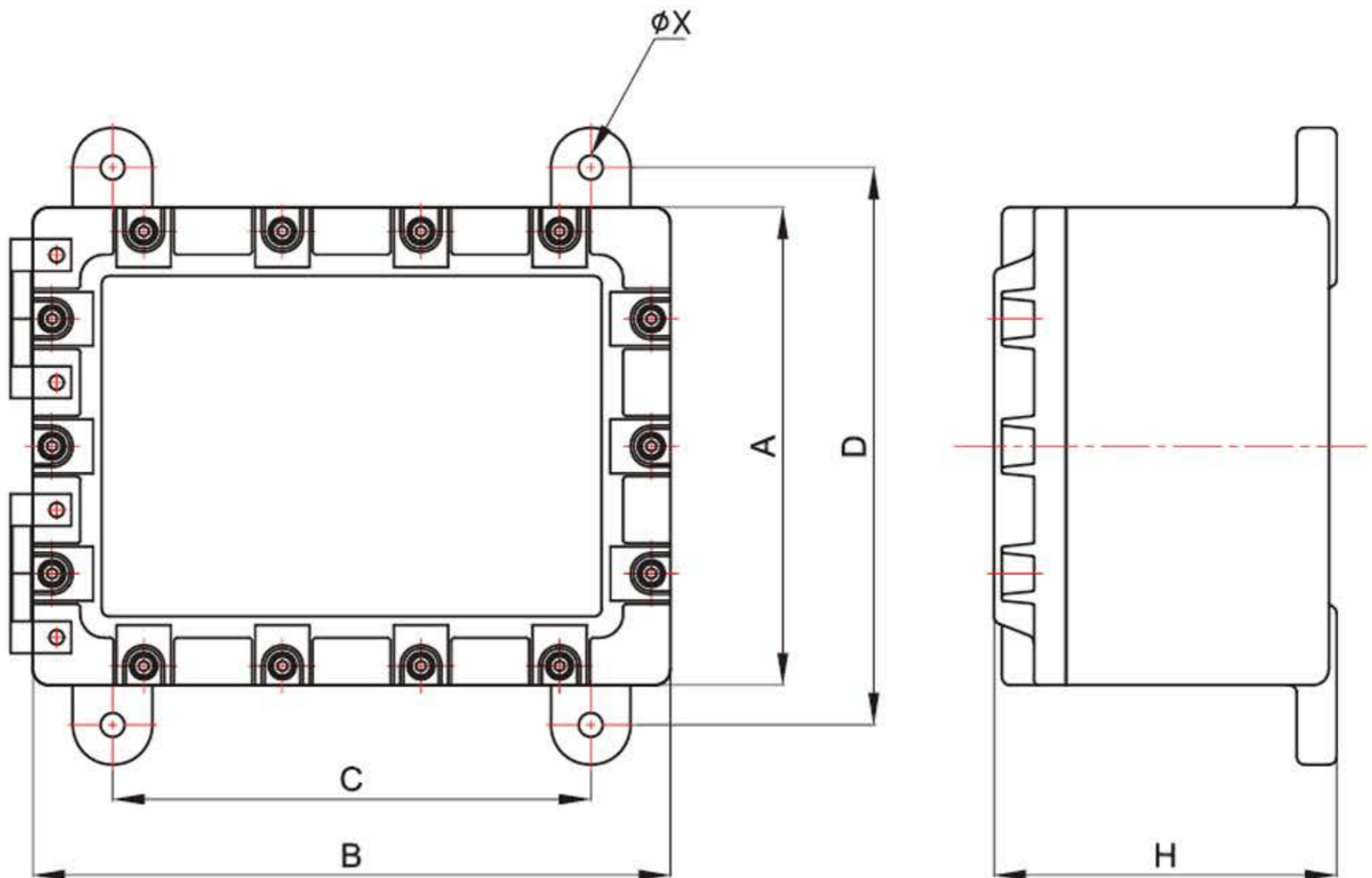

Data

방폭 등급 : Ex d IIB+H2 T6 IP65 / Ex tD A21 T85°C IP65								
박스규격	Max. T/B	Cover	Dimension(mm)					
	(20A)	M3.0 x 1.5P	A	B	C	D	ØX	H
150X220X132	10 P	3	150	220	185	165	10	130
180X220X135	12 P	3	180	220	220	160	10	130
220X230X136	15 P	6	220	230	255	187	10	135
200X300X150	20 P	7	220	300	245	245	10	150
220X330X130	20 P	8	220	330	255	280	12	135
250X350X150	30 P	9	250	350	290	270	10	160
250X500X180	40 P	12	250	500	295	300	10	150
300X300X195	30 P	9	300	300	340	240	12	200
300X400X210	40 P	15	300	400	350	300	12	210
310X420X150	40 P	15	310	420	340	360	12	150
300X500X230	50 P	18	300	500	355	415	12	230
350X450X230	50 P	15	350	450	410	350	12	240
340X500X210	50 P	18	340	500	380	370	12	205
400X400X260	40 P	16	400	400	460	300	12	260
400X500X225	60 P	24	400	500	460	400	15	235
400X600X235	80 P	32	400	600	460	500	15	235
400X700X260	100 P	38	400	700	475	570	15	260
500X500X230	100 P	36	500	500	560	400	15	230
500X600X260	120 P	48	500	600	550	500	15	260
500X700X290	120 P	54	500	700	565	595	15	290
600X600X255	140 P	64	600	600	660	490	15	280
600X700X300	180 P	72	600	700	660	560	15	300
600X800X300	180 P	88	600	800	660	660	18	300
700X1000X310	200 P	126	600	1000	770	850	20	310

Max. Size hubs that can be used

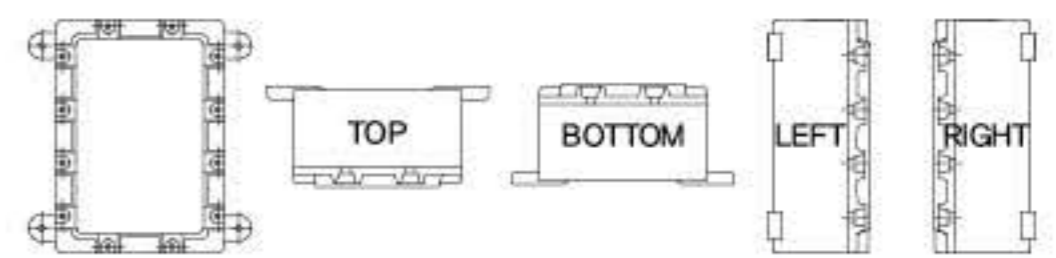

Connection Hub Type : Top&Bottom, Left&Right / Max HUB Q'TY (PF, NPT, M)									
박스규격	1/2"	3/4"	1"	1 1/4"	1 1/2"	2"	2 1/2"	3"	4"
	(16C)	(22C)	(28C)	(36C)	(42C)	(54C)	(70C)	(82C)	(104C)
	M20	M25	M32	M40	M50	M63	M75	M90	M110
150X220X132	3/5	2/3	2/3	1/2	1/2	1/1	-/1	-/-	-/-
180X220X135	5/5	3/3	2/2	2/2	-/-	-/-	-/-	-/-	-/-
220X230X136	5/5	3/4	3/3	2/2	2/2	2/2	1/1	-/-	-/-
200X300X150	5/7	4/7	3/4	2/3	2/3	2/3	1/2	-/-	-/-
220X330X130	4/6	4/5	3/5	3/4	2/3	1/2	-/-	-/-	-/-
250X350X150	6/10	6/9	5/7	3/4	3/3	2/3	1/2	-/-	-/-
250X500X180	6/12	5/11	4/6	3/5	2/5	2/4	1/3	-/-	-/-
300X300X195	10/10	9/9	7/7	4/4	3/3	3/3	2/2	2/2	-/-
300X400X210	10/14	9/13	7/11	4/5	3/4	3/4	2/3	2/3	-/-
310X420X150	8/11	7/9	4/5	3/4	3/4	2/3	2/3	-/-	-/-
300X500X230	10/18	10/18	7/13	5/9	5/9	3/5	2/3	2/3	-/-
350X450X230	13/17	12/15	10/12	5/7	5/6	4/5	2/3	2/3	-/-
340X500X210	13/18	12/16	10/13	5/8	5/6	4/5	2/3	2/3	-/-
400X400X260	20/20	16/16	7/7	7/7	7/7	7/7	4/4	3/3	-/-
400X500X225	14/18	13/16	11/13	5/6	4/6	4/5	3/4	2/3	-/-
400X600X235	14/22	13/20	11/16	5/7	4/7	4/6	3/4	2/4	-/-
400X700X260	14/26	13/23	11/19	5/8	4/8	4/6	3/5	2/4	-/-
500X500X230	18/18	16/16	13/13	6/6	6/6	5/5	4/4	3/3	-/-
500X600X260	26/32	23/29	13/15	11/13	9/11	7/9	4/5	3/4	-/-
500X700X290	27/35	24/35	20/29	11/17	11/15	9/11	7/9	3/4	-/-
600X600X255	32/32	26/26	15/15	13/13	13/13	6/6	-/5	4/4	3/3
600X700X300	28/32	24/28	18/21	12/15	10/12	8/9	6/7	4/4	2/2
600X800X300	15/21	15/21	7/10	6/8	6/8	5/7	4/6	3/5	-/-
700X1000X310	18/27	18/27	9/13	8/11	7/10	6/9	4/6	4/5	-/-



제품 특징

Features

- ▶ 폭발 위험 물질 계량 및 PSM(Process Safety Management) / 화관법 / 화평법 적용 대상 업체에 사용
- ▶ 석유화학, 화학계열, 도료, 잉크, 가스, LPG 등 폭발 위험성이 있는 제품 업체에 사용