



Since 1994, DIGITAL LEADER Axis Sensitive Co. Ltd
Industrial Explosion Proof Load Cell



MODEL : SB14-EXP



www.axis123.com



RoHS compliant



제품 규격 [UNIT : mm]

Product Specification

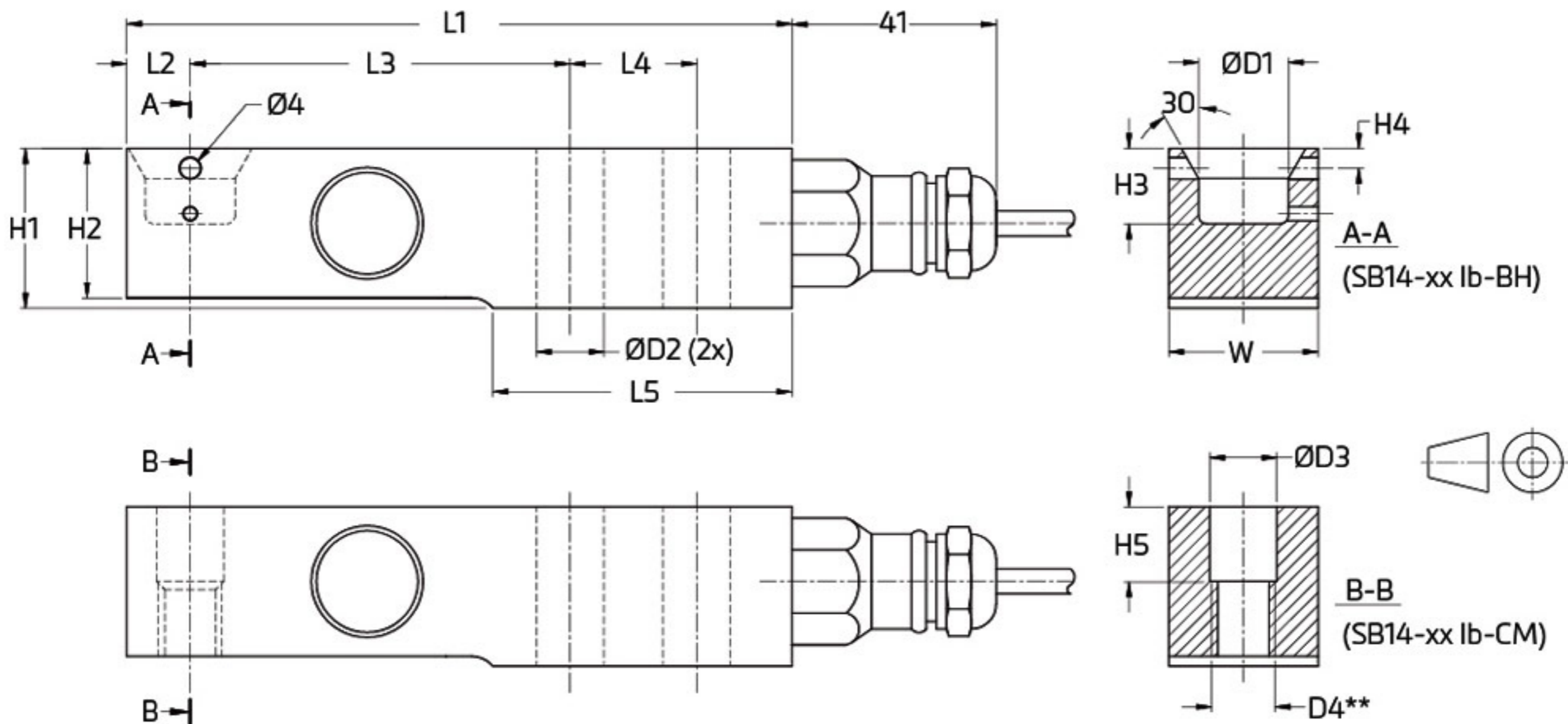

Type	L1	L2	L3	L4	L5	H1	H2	H3	H4	H5	W	D1	D2	D3	D4	Mounting bolts	Torque *
500/1000 lb	133.4	12.7	76.2	25.4	59.9	31	28.8	15	4	15	30	18	13	13.5	M12	M12 8.8	90 Nm
2500 lb	133.4	12.7	76.2	25.4	59.9	31	30.5	15	4	15	30	18	13	13.5	M12	M12 8.8	90 Nm
5000 lb	133.4	12.7	76.2	25.4	59.9	31	30.5	15	4	15	30	18	13	13.5	M12	M12 10.9	120 Nm
10,000 lb	177.8	19.1	95.3	38.1	92.7	43.6	38.1	20.5	8	20.1	43	25	21	21.5	M20	M20 8.8	400 Nm

* Torque values assume oiled threads.

** Unified thread 1/2-20 UNF (500...5000 lb) and 3/4-16 UNF (10000 lb) is available. Type designation SB14-xx-CU.

The load cell is provided with a shielded, 4 conductor cable (AWG 24).

Cable jacket: polyurethane

Cable length: 3 m for SB14-500lb to 5,000lb, 4.5 m for SB14-10,000lb

Cable diameter: 5 mm

The shield is floating (On request the shield can be connected to the load cell body)

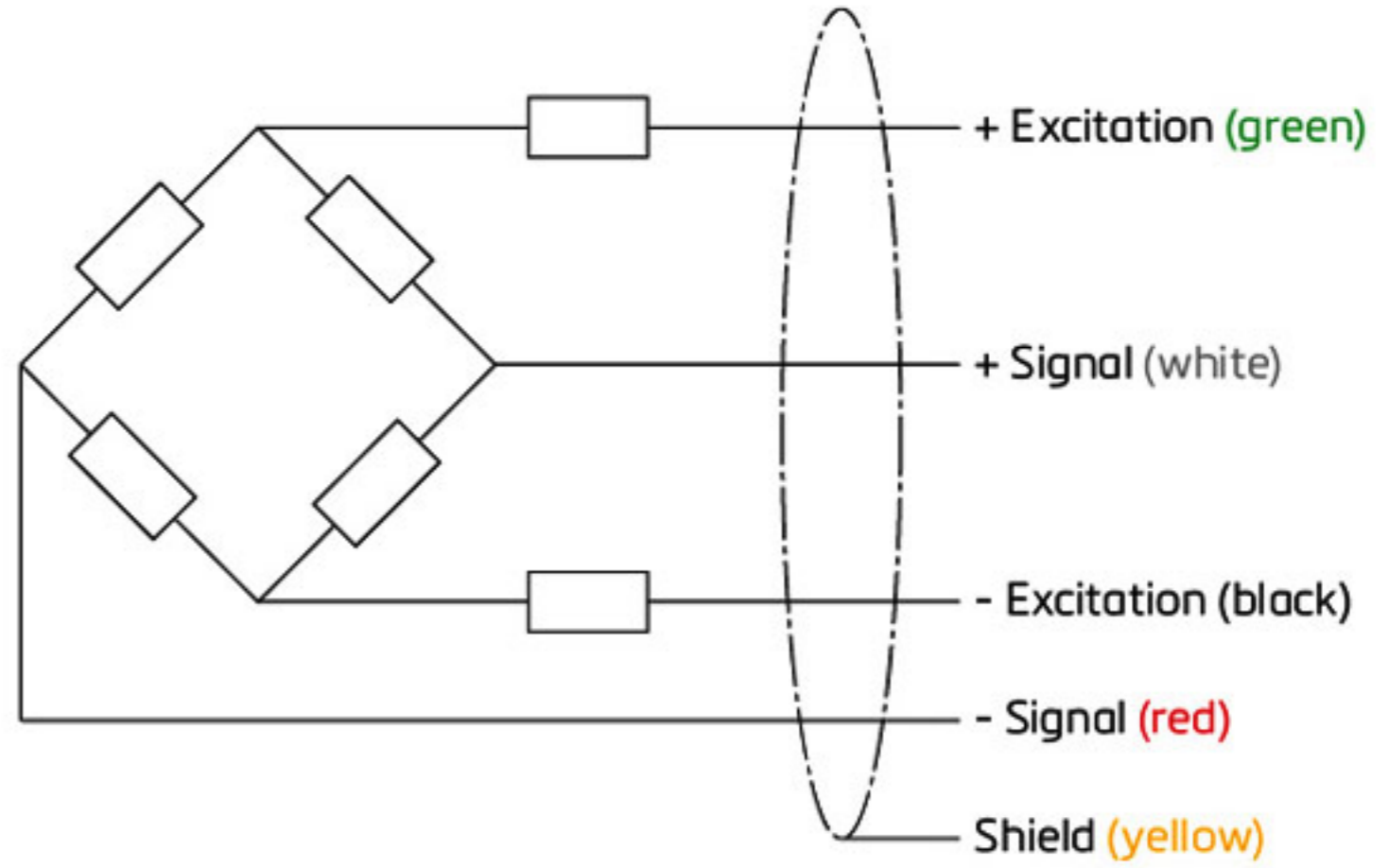

- ▶ SB6는 20kg~204kg 까지의 고정밀 계량 어플리케이션을 위한 로드셀
- ▶ Stainless Steel 구조와 완벽한 밀폐 봉인된 독특한 벤딩 빔 로드셀로 최적의 계량 성능 보장, 최적의 계량 성능을 보장

Maximum capacity (E_{max})	klb	0.5 / 1 / 2.5 / 5 / 10*		0.5 / 1 / 2.5 / 5
Metric equivalents (1 lb=0.45359 kg)	kg	227 / 454 / 1134 / 2,268 / 4,536		227 / 454 / 1,134 / 2,268
Accuracy class according to OIML R60		(GP)	C3	C3 MI 6
Maximum number of verification intervals (n_{max})		n.a.	3,000	3,000
Minimum load cell verification interval (v_{min})		n.a.	$E_{max} / 11,500$	
Temperature effect on minimum dead load output (TC_0)	%*RO/10°C	± 0.0400	± 0.0122	
Temperature effect on sensitivity (TC_{RO})	%*RO/10°C	± 0.0200	± 0.0100	

Temperature effect on minimum dead load output (TC ₀)	%*RO/10°C	± 0.0400	± 0.0122	
Temperature effect on sensitivity (TC _{RO})	%*RO/10°C	± 0.0200	± 0.0100	
Combined error	%*RO	± 0.0500	± 0.0200	± 0.0180
Non-linearity	%*RO	± 0.0400	± 0.0166	± 0.0166
Hysteresis	%*RO	± 0.0400	± 0.0166	± 0.0083
Creep error (30 minutes) / DR	%*RO	± 0.0600	± 0.0166	± 0.0083
Optional Min.load cell verification interval (v _{min opt})		n.a.	E _{max} / 23,000	
Optional Temp. effect on min. dead load output (TC _{0 opt})	%*RO/10°C	n.a.	± 0.0061	
Rated Output (RO)	mV/V	2 ± 0.1%		
Calibration in mV/V/Ω (A...I classified)	%	± 0.05 (± 0.005)		
Zero balance	%*RO	± 5		
Excitation voltage	V	5..15		
Input resistance (R _{LC})	Ω	1,100 ± 50		
Output resistance (R _{out})	Ω	1,000 ± 2		
Insulation resistance (100 V DC)	MΩ	≥ 5,000		
Safe load limit (E _{lim})	%*E _{max}	200		
Ultimate load	%*E _{max}	300		
Safe side load	%*E _{max}	100		
Compensated temperature range	°C	-10...+40		
Operating temperature range	°C	-40...+80 (ATEX -40...+60)		
Load cell material		stainless steel 17-4 PH (1.4548)		
Sealing		cable entry hermetically sealed by glass to metal header		
Protection according EN 60 529		IP68 (up to 2m water depth) / IP69K		
Packet weight	kg	1.2 (500-5,000lb), 2.44 (10,000lb)		

The limits for Non-Linearity, Hysteresis, and TC_{RO} are typical values.

The sum of Non-linearity, Hysteresis and TC_{RO} meets the requirements according to OIML R60 with p_{LC}=0.7.

* Only available in GP version.

- **Stainless Steel 구조**
- **낮은 용량 범위**
- **높은 명중률**
- **밀폐 봉인 구조**