



Since 1994, DIGITAL LEADER Axis Sensitive Co. Ltd
Industrial Explosion Proof Load Cell



MODEL : PC7-EXP



RoHS
compliant

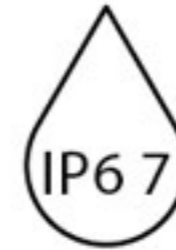

제품 규격 [UNIT : mm]

Product Specification

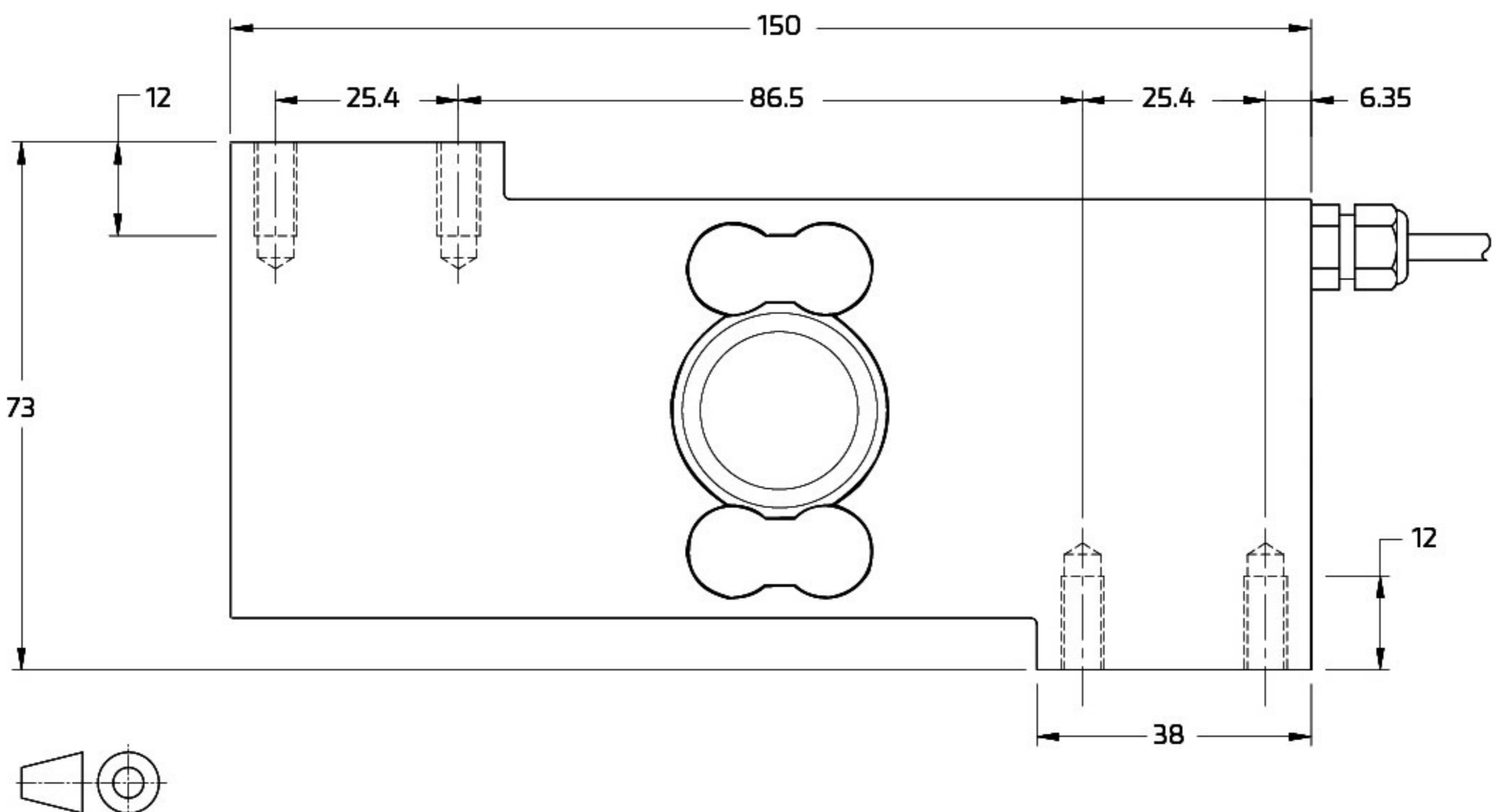

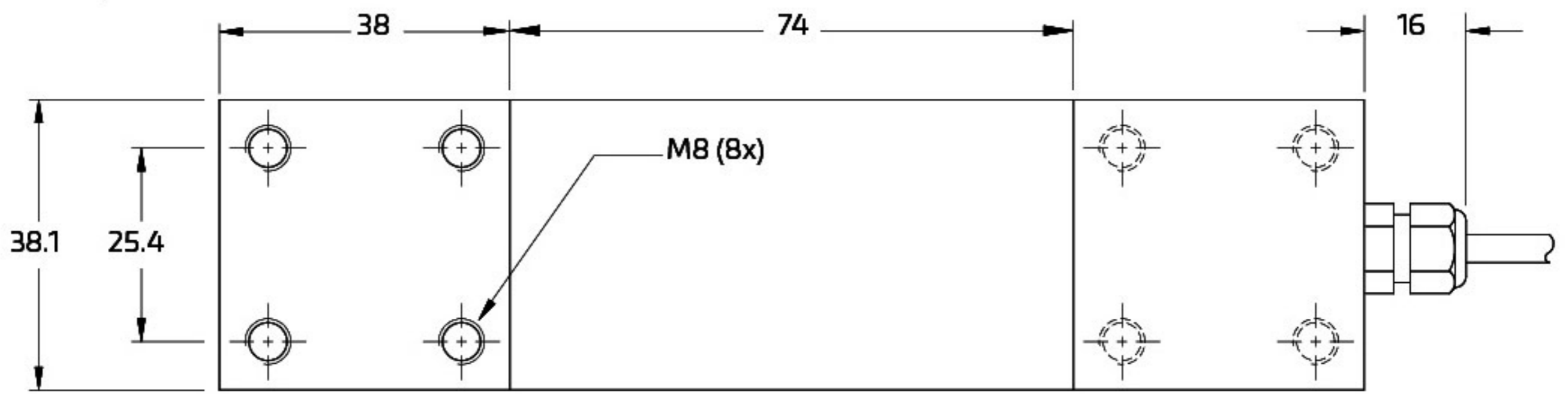

The load cell is provided with a shielded, 6 conductor cable (AWG 26).

Cable jacket: polyurethane

Cable length: 3 m

Cable diameter: 5.8 mm

The shield is floating or connected to the load cell body

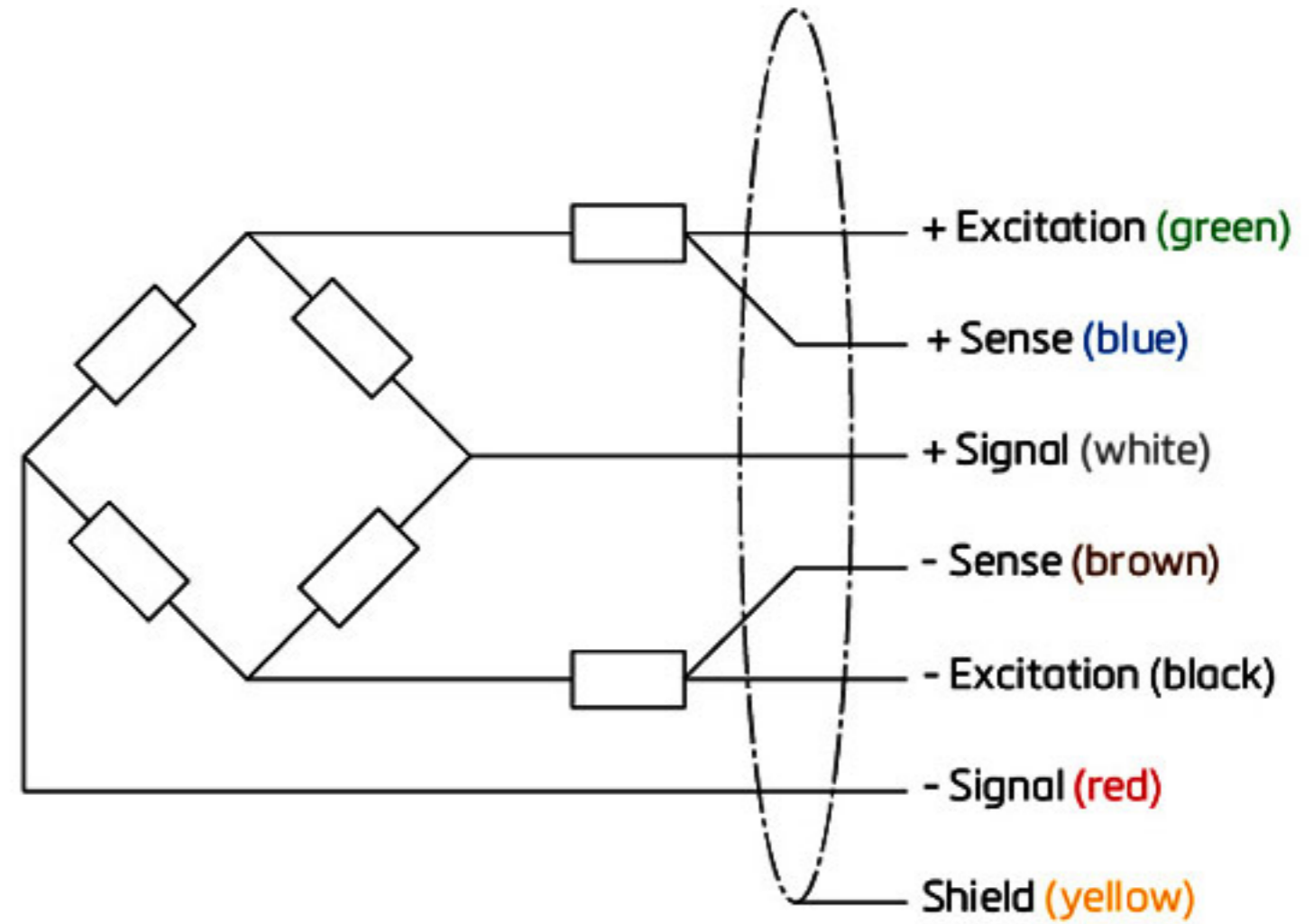

- ▶ 싱글 타입으로 100kg, 200kg, 500kg의 용량은 PC6 & PCB 모델과 호환 가능
- ▶ 레이저 용접 커버가 있는 일렉트로 슈드 스테인레스 강으로 제작
- ▶ 견고한 구조는 해양 및 식품, 제약, 음료 분야의 계량기에 이상적인 제품
- ▶ 벤치형 저울 / 소형 플랫폼 / 고속 중량 선별기 등

Maximum capacity (E_{max})	kg	100 / 250 / 500			
Accuracy class according to OIML R60		(GP)	C3	C3 MI6	C4
Maximum number of verification intervals (n_{LC})		n.a.	3,000		4,000
Minimum load cell verification interval (v_{min})		n.a.	$E_{max} / 12,500$		
Temperature effect on minimum dead load output (TC_0)	%*RO/10°C	± 0.0400	± 0.0112		
Temperature effect on sensitivity (TC_{RO})	%*RO/10°C	± 0.0200	± 0.0100		± 0.0080
Combined error	%*RO	± 0.0500	± 0.0200	± 0.0180	± 0.0180
Non-linearity	%*RO	± 0.0400	± 0.0166	± 0.0166	± 0.0125
Hysteresis	%*RO	± 0.0400	± 0.0166	± 0.0083	± 0.0125
Creep error (30 minutes) / DR	%*RO	± 0.0600	± 0.0166	± 0.0083	± 0.0125
Maximum off centre loading effect	%*RO/mm	± 0.00035	± 0.00011		± 0.00008
Optional: Min. load cell verification interval ($v_{min opt}$)		n.a.	$E_{max} / 15,000$		
Optional: Temp. effect on min. dead load output ($TC_0 opt$)	%*RO/10°C	n.a.	± 0.0093		
Rated Output (RO)	mV/V	2 ± 5%			
Zero balance	%*RO	± 5			
Excitation voltage	V	5...15			
Input resistance (R_{LC})	Ω	380 ± 20			
Output resistance (R_{out})	Ω	350 ± 10			
Insulation resistance (100 V DC)	MΩ	≥ 5,000			
Safe load limit (E_{lim})	%* E_{max}	200			
Ultimate load	%* E_{max}	300			
Safe side load	%* E_{max}	100			
Maximum platform size; loading acc. to OIML R76	mm	600 x 600			
Maximum off centre distance at maximum capacity	mm	200			
Compensated temperature range	°C	-10...+40			
Operating temperature range	°C	-40...+80 (ATEX -40...+60)			
Load cell material		stainless steel 17-4 PH (1.4548)			
Sealing		complete hermetic sealing			
Protection according EN 60 529		IP68 (up to 2 m water depth) / IP69K			
Packet weight	kg	2.5			

- ▶ **Stainless Steel 구조 / 완전 용접 구조**
- ▶ **일렉트로 폴리싱 처리 / 높은 정확도**
- ▶ **플랫폼 규격 600 X 600mm**
- ▶ **로드셀 케이블 : 폴리 우레탄 3m x 5.8mm**
- ▶ **EN 60 529에 따른 보호 : IP 68(up to 2m) / 69K**

모 델	용 량 (kg)	집판규격 (mm)	등 급	재 질
PC 22	5,20,30,40	350 × 350	C3	Aluminum
PC 42	5,10,20,30,50,100,200	400 × 400	C3	Aluminum
PC 46	50,100,150,200,250	400 × 400	C4	Aluminum
PC 1	7.5,10,15,30,50,75,100,200	600 × 600	C4	Stainless Steel
PC 6	10,20,50,100,200	600 × 600	C4	Stainless Steel
PC 7	100,250,500	600 × 600	C4	Stainless Steel
PC 60	30,50,100,150,200,300,500,750	600 × 600	C3	Aluminum
PC 12	20	600 × 600	C3	Stainless Steel
PC 2	20	600 × 600	G3*	Stainless Steel
	150	1000 × 1000	G3*	Stainless Steel
PCB	50/100/250/500/1000	1000 × 1000	C3M16	Stainless Steel
PC 2H	2000	1200 × 1200	C3	Stainless Steel